

Section 6.4 Scale Models

1. Anthony is constructing a scale model of this building. He will use a scale of 10 m represents 1 cm.

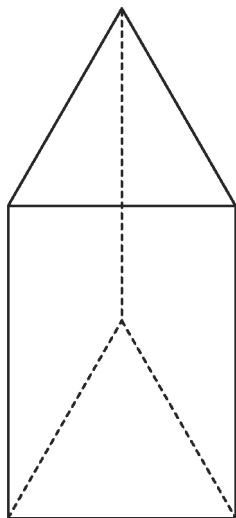

The base of the building is in the shape of an equilateral triangle with sides 40 m long. The height of the building is 400 m.

- Find the measures of the height and one side of the base of the model.
 - Make a scale model of the building.
2. The owner of a major league baseball team is considering moving the team to a new stadium. She plans to have several architectural firms submit scale models of their stadium designs. How would examining the scale models help the owner make her decision?
3. Annie is building a scale model of an above-ground rectangular pool. The pool is 18 ft long by 15 ft wide by 4 ft deep. She plans to use the scale 2 cm represents 1 ft. What will be the dimensions of the model?

4. The floor plan of a new house is drawn to scale.

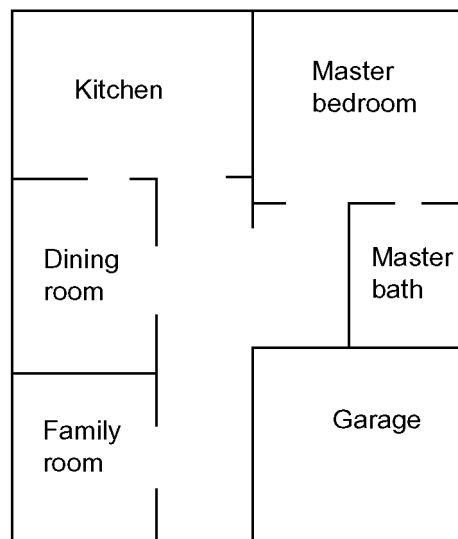

The scale used was 1 cm represents 6 ft. Find the actual dimensions of each room.

- family room
 - bedroom
 - dining room
 - garage
5. Cole is using this isometric perspective drawing of a bookshelf to draw plans. The distance between a pair of dots represents 1 ft. Draw plans to show each part required. Include measurements.

